

Material:	
Contact Solder Pin:	Brass, 120-240µ" Sn over 80-120µ" Ni
Insulating Body:	PA46 (glass Filled), UL94V-0 Suitable for Reflow
Cover Plastic (Optional):	Polyamide, PA46
Electrical	
Voltage Rating:	300 VAC
Current rating:	10 Amps
Withstand Voltage:	1500 VAC, Test time 60 sec
Mechanical	
Operating Temperature:	-40°C to +105°C -40°F to +221°F
Soldering Temperature:	260°C, 500°F for 5 seconds
Safety Approval:	UL US

Part Number Configuration.

PS5X4-XX-01X

* Pin Height Option
See Chart Below

Number of
Positions

Packaging Option
0-Bulk
1-Tape and Reel
(Cover on all pins)
2-Tape and Reel
cover on center pins

PS524	Dim L = 6.50mm
PS534	Dim L = 13.00mm
PS544	Dim L = 14.20mm
* PS554	Dim L = 10.15mm
PS564	Dim L = 15.50mm
PS574	Dim L = 12.70mm

Pickup Covers (Optional)

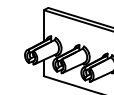

3 Pole Cover for
Odd # of poles



2 Pole Cover for
Even # of poles

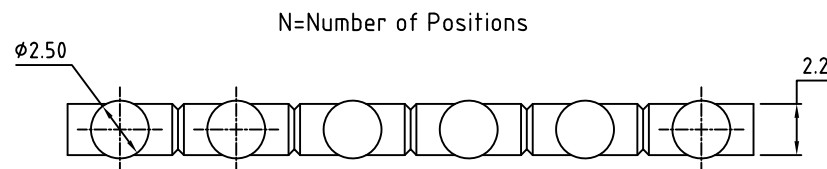

N=Number of Positions

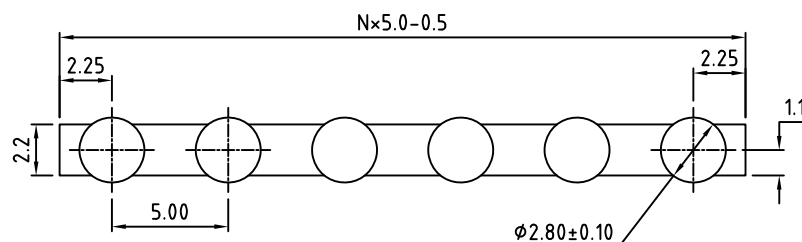

PCB Layout

Max Number of Positions = 24

UNLESS OTHERWISE
SPECIFIED BREAK ALL
SHARP EDGES AND
DEBURR ALL HOLES

TITLE: 5.00mm SPACING, PIN STRIP
WITH OPTIONAL PICK AND PLACE COVER

LIMITS: UNLESS
OTHERWISE SPECIFIED
HUND. ± 0.02 FRACT. ± 1/64
THOU. ± 0.005 ANGLE ± 1°

SCALE THIS IS A CONFIDENTIAL DRAWING AND
MUST BE TREATED AS SUCH. NO
DISTRIBUTION IS ALLOWED WITHOUT
WRITTEN APPROVAL BY EBY ELECTRO INC.

EBY Electro Inc.
PLAINVIEW, NY 11803

IMPORTANT DISCLAIMER: All information provided on this print is for reference. Always perform your own tests and acquire samples and further information to determine product suitability. While we make effort to provide accurate information, we cannot be responsible for errors either of omission or typographical. EBY Electro, Inc. assumes no responsibility for the use or suitability of any product. All products and specifications are subject to change without prior written notice.

METRIC LIMITS
ONE PLACE ± 0.3
TWO PLACES ± 0.10
ANGLE ± 1°

DRAWN JM DATE 05/06/08
CHECKED DATE
APPROVED DATE

SIZE A
DRAWING NUMBER:

PS5X4-XX-01X

REV. Q