

N=NUMBER OF CONTACTS

DIM		TOL		
		2P	3P--4P	5P--8P
Dim A	Nx15.0-5	±0.50	±0.50	±0.60
Dim B	(N-1)x15.0	±0.25	±0.50	±0.60

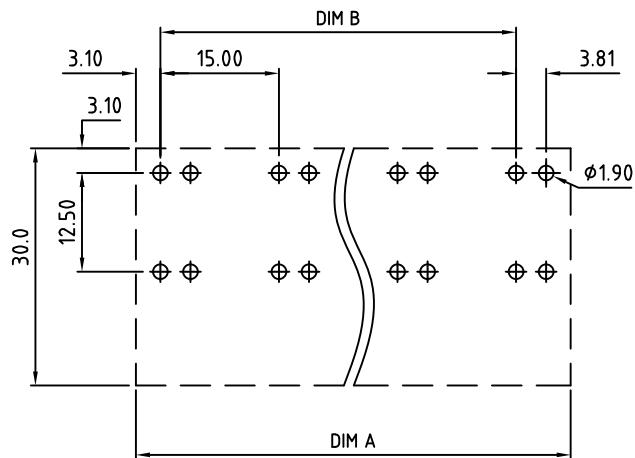
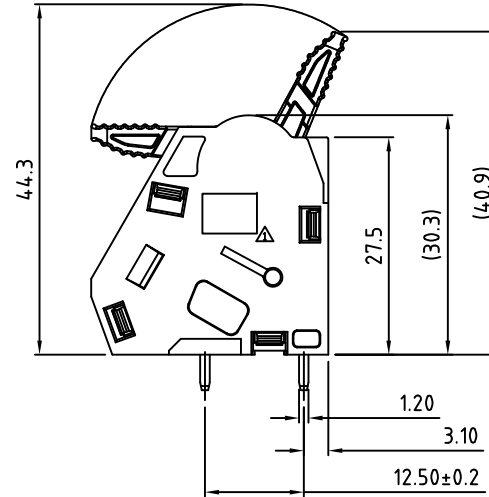
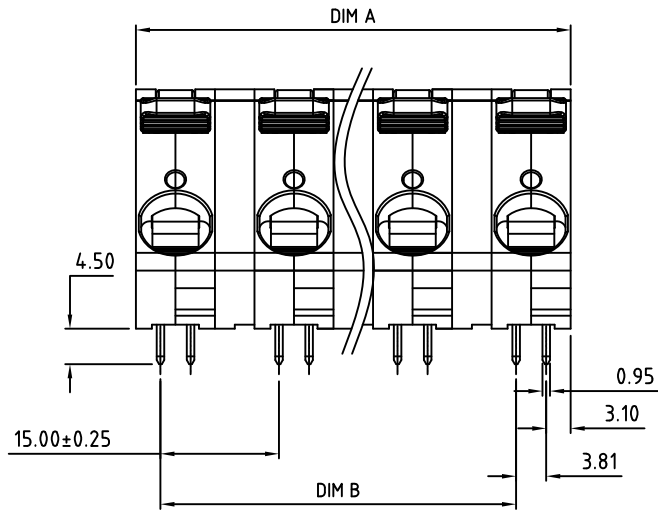

PCB Layout

Material:	
Contact:	Copper, Matte Tin over Ni Plating
Wire Retention Spring:	Stainless Steel
Lever:	Thermoplastic, UL94V-0, White, RAL9003
Insulating Body:	Thermoplastic, UL94V-0
Electrical	
Voltage Rating:	600 VAC
Current rating:	65 AMPS
Withstand Voltage:	2200 VAC, Test time 60 sec
Wire Range:	6-16 AWG
Mechanical	
Wire Strip Length:	12-13mm
Operating Temperature:	-40°C to +115°C -40°F to +239°F
Soldering Temperature:	260°C, 500°F for 5 seconds
Safety Approval:	CSA US

Part Number Configuration.

EB4210-XX-X01

Number of Positions

Body Color

- 0 Black (RAL9005)
- 2 Red (RAL3001/D)
- 3 Orange(RAL2011/P)
- 4 Yellow(RAL1018/A)
- 5 Green(RAL6018/T)
- 6 Blue (RAL5015/A)
- 8 Grey(RAL7004/P)
- 9 White(RAL1102)

UNLESS OTHERWISE SPECIFIED BREAK ALL SHARP EDGES AND DEBURR ALL HOLES

TITLE:

15.00mm Spacing, Modular

LIMITS: UNLESS OTHERWISE SPECIFIED
 HUND.±.02 FRACT.±1/64
 THOU.±.005 ANGLE±1°

SCALE

THIS IS A CONFIDENTIAL DRAWING AND MUSTBE TREATED AS SUCH. NO DISTRIBUTION IS ALLOWED WITHOUT WRITTEN APPROVAL BY EB4 ELECTRO INC.



PLAINVIEW, NY 11803

IMPORTANT DISCLAIMER: All information provided on this print is for reference. Always perform your own tests and acquire samples and further information to determine product suitability. While we make effort to provide accurate information, we cannot be responsible for errors either of omission or typographical. EB4 Electro, Inc. assumes no responsibility for the use or suitability of any product. All products and specifications are subject to change without prior written notice.

METRIC LIMITS
 ONE PLACE ±0.3
 TWO PLACES ±0.10
 ANGLE ± 1°

DRAWN MWP DATE 08/29/18
 CHECKED DATE
 APPROVED DATE

SIZE
A

DRAWING NUMBER:
EB4210-XX-X01

REV.