

Mates With
EB1788-XX-500
EB1788-XX-510

Material:	
Contact Block:	Brass, Nickel Plated
Contact Pin:	Copper, Tin Plated
Screw:	M3.5, Steel, Zinc Plated, "-" slotted
Insulating Body:	Polyamide, UL94V-0, Green
Electrical	
Voltage Rating:	600 VAC
Current rating:	41 AMPS
Withstand Voltage:	1.6KV
Wire Range:	8-24 AWG
Wire Strip Length:	10-11mm
Mechanical	
Torque:	9.0 lbs-in. Max
Operating Temperature:	-40°C to +105°C
	-40°F to +221°F
Safety Approval:	US

N=Number of Positions

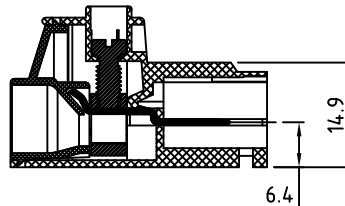
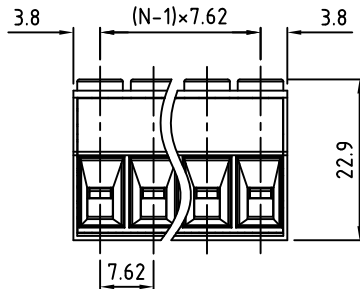

Part Number Configuration.

EB1789-XX-500

Number of Positions: X
Color: 5-Green

(Other Color Options Available)
(Please consult Factory)

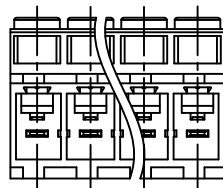

Max Number of Positions = 16

UNLESS OTHERWISE SPECIFIED BREAK ALL SHARP EDGES AND DEBURR ALL HOLES

TITLE: 7.62mm SPACING, PLUGGABLE BLOCK FLAT PINS

LIMITS: UNLESS OTHERWISE SPECIFIED HUND.±.02 FRACT.±1/64 THOU.±.005 ANGLE±1°	SCALE	THIS IS A CONFIDENTIAL DRAWING AND MUSTBE TREATED AS SUCH. NO DISTRIBUTION IS ALLOWED WITHOUT WRITTEN APPROVAL BY EBYS ELECTRO INC.	Electro Inc. PLAINVIEW, NY 11803
	DRAWN JM DATE 08/19/10		

IMPORTANT DISCLAIMER: All information provided on this print is for reference. Always perform your own tests and acquire samples and further information to determine product suitability. While we make effort to provide accurate information, we cannot be responsible for errors either of omission or typographical. EBYS Electro, Inc. assumes no responsibility for the use or suitability of any product. All products and specifications are subject to change without prior written notice.

METRIC LIMITS ONE PLACE ±0.3 TWO PLACES ±0.10 ANGLE ± 1°	CHECKED _____ APPROVED _____	DATE _____ DATE _____	DRAWING NUMBER: EB1789-XX-500	REV.
---	---------------------------------	--------------------------	----------------------------------	------