

RoHS Compliant

Rev.	ECO#	Date	By
E	0267-0313	03/12/13	AJT

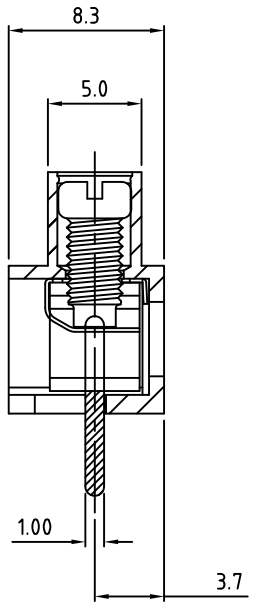
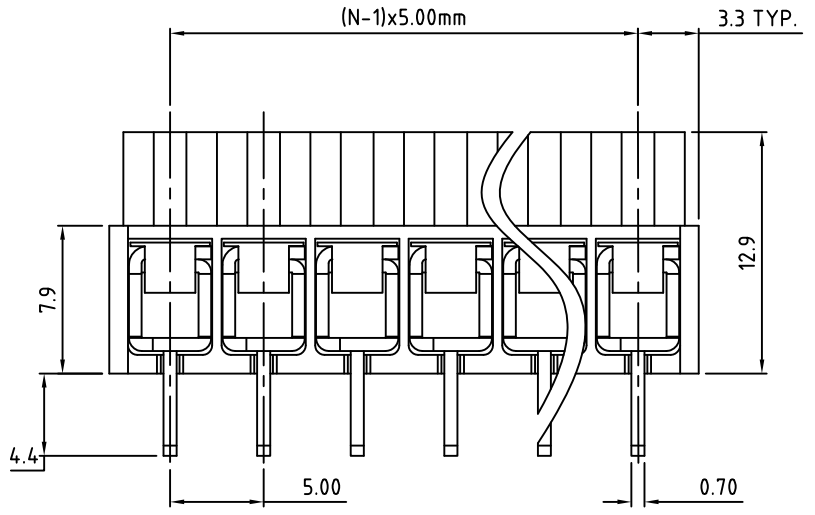
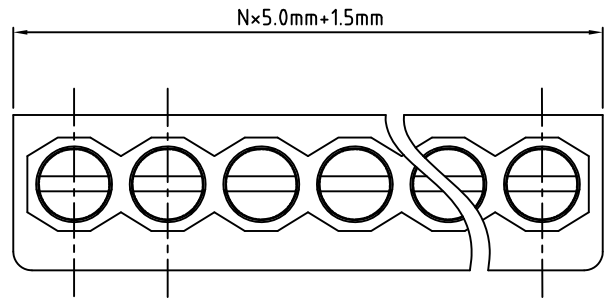

Material:	
Contact Block:	Brass Stamped, Ni Plated
Contact Solder Pin:	Brass, Tin Plated
Wire Guard:	Stainless Steel
Screw:	M3, Steel, Zinc Plated, "-" slot
Insulating Body:	Polyamide, UL94V-0, Green
Electrical	
Voltage Rating:	300 VAC
Current rating:	10 AMPS
Withstand Voltage:	1500 VAC, Test time 60 sec
Wire Range:	12-20 AWG
Mechanical	
Torque:	3.5 Lbs-in. Max
Operating Temperature:	-40°C to +115°C -40°F to +239°F
Soldering Temperature:	260°C, 500°F for 5 seconds
Safety Approval:	US

Part Number Configuration.

EB610-XXDS-5X0

Number of Positions: 5
Color Option: 5-Green
Screw Option: 0- "-" Slot, 1- "-/+" Slot

(Other Color Options Available)
Please consult Factory

Max Number of Positions = 24

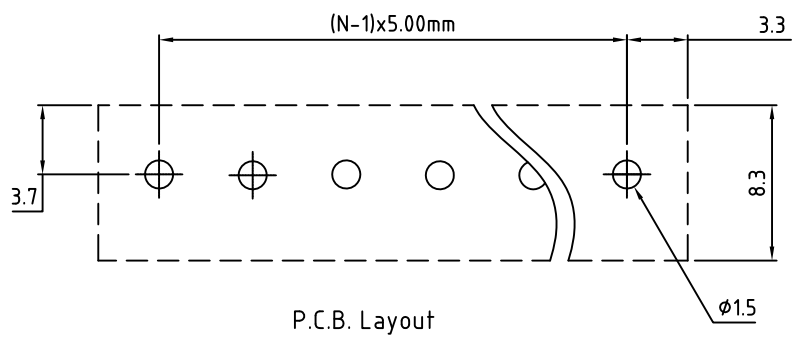

P.C.B. Layout

UNLESS OTHERWISE SPECIFIED BREAK ALL SHARP EDGES AND DEBURR ALL HOLES

TITLE: 5.00mm SPACING, WIRE GUARD BLOCK WIRE ENTRY ON FRONT & BACK

LIMITS: UNLESS OTHERWISE SPECIFIED HUND. ±0.2 THOU. ±0.05	FRACT. ±1/64 ANGLE ±1°	SCALE	THIS IS A CONFIDENTIAL DRAWING AND MUST BE TREATED AS SUCH. NO DISTRIBUTION IS ALLOWED WITHOUT WRITTEN APPROVAL BY EB ELECTRO INC.	Electro Inc. PLAINVIEW, NY 11803
---	---------------------------	-------	--	-------------------------------------

IMPORTANT DISCLAIMER: All information provided on this print is for reference. Always perform your own tests and acquire samples and further information to determine product suitability. While we make effort to provide accurate information, we cannot be responsible for errors either of omission or typographical. EB Electro, Inc. assumes no responsibility for the use or suitability of any product. All products and specifications are subject to change without prior written notice.

METRIC LIMITS ONE PLACE ±0.3 TWO PLACES ±0.10 ANGLE ±1°	DRAWN: JM CHECKED: _____ APPROVED: _____	DATE: 07/18/08 DATE: _____ DATE: _____	SIZE: A	DRAWING NUMBER: EB610-XXDS-5X0	REV.: E
--	--	--	---------	--------------------------------	---------