

N=Number of Positions

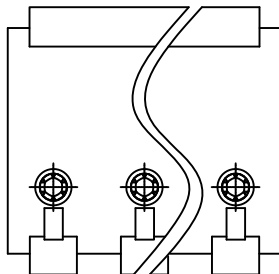
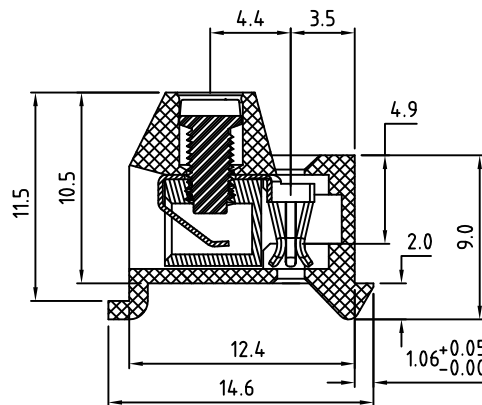
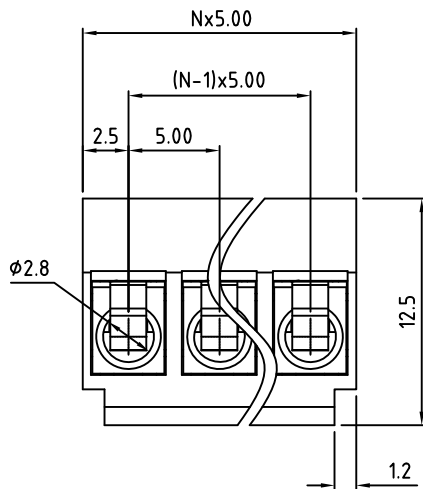

Material:	
Contact Block:	Brass, Ni Plated
Wire Guard:	PhBz, Tin Plated
Screw:	M2.6, Steel Zinc Plated
Insulating Body:	Polyamide, UL94V-0
Electrical	
Voltage Rating:	300 VAC
Current rating:	10 AMPS
Withstand Voltage:	1500 VAC, Test time 60 sec
Wire Range:	14-24 AWG
Mechanical	
Torque:	3.5 Lbs-in. Max
Operating Temperature:	-40°C to +115°C -40°F to +239°F
Safety Approval:	CSA US

Part Number Configuration.

EB557-XXDS-0X0

Number of Color Positions 0-Black
Screw Option 0-Slotted "-"
3-Phil Slot "+"

Note:

Mates with a $\phi 1.1$ mm pin.

(Other Color Options Available)
Please consult Factory

Max Number of Positions = 24

UNLESS OTHERWISE SPECIFIED BREAK ALL SHARP EDGES AND DEBURR ALL HOLES	TITLE:	THIS IS A CONFIDENTIAL DRAWING AND MUST BE TREATED AS SUCH. NO DISTRIBUTION IS ALLOWED WITHOUT WRITTEN APPROVAL BY EB ELECTRO INC.	
	5.00mm SPACING, PLUGGABLE BLOCK 6-FINGER INVERTED CLIP, CHASSIS MOUNT		
LIMITS: UNLESS OTHERWISE SPECIFIED HUND. ± 0.02 THOU. ± 0.005	SCALE		
ONE PLACE ± 0.3 TWO PLACES ± 0.10 ANGLE $\pm 1^\circ$			

IMPORTANT DISCLAIMER: All information provided on this print is for reference. Always perform your own tests and acquire samples and further information to determine product suitability. While we make effort to provide accurate information, we cannot be responsible for errors either of omission or typographical. EB Electro, Inc. assumes no responsibility for the use or suitability of any product. All products and specifications are subject to change without prior written notice.

METRIC LIMITS	DRAWN	DATE	SIZE	DRAWING NUMBER:	REV.
ONE PLACE ± 0.3 TWO PLACES ± 0.10 ANGLE $\pm 1^\circ$	MWP	10/02/09	A	EB557-XXDS-0X0	
	CHECKED	DATE			
	APPROVED	DATE			