

RoHS Compliant

Rev.	Description/Eco	Date	By
------	-----------------	------	----

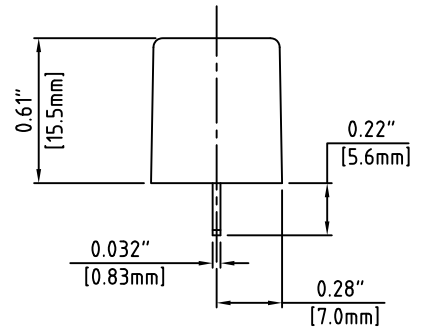

N=Number of Positions

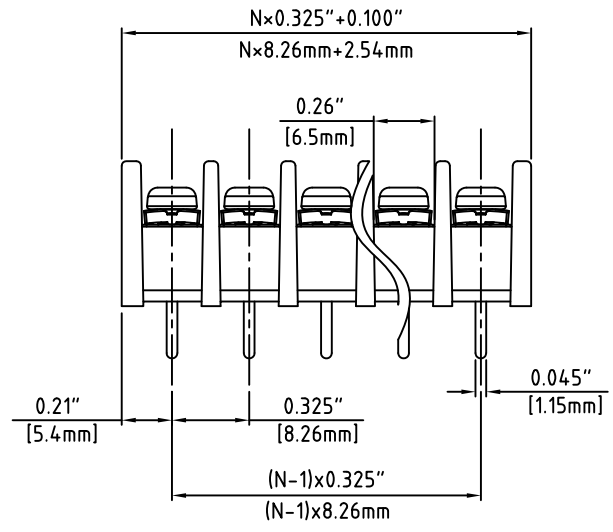
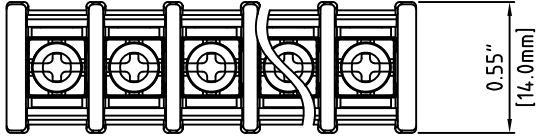
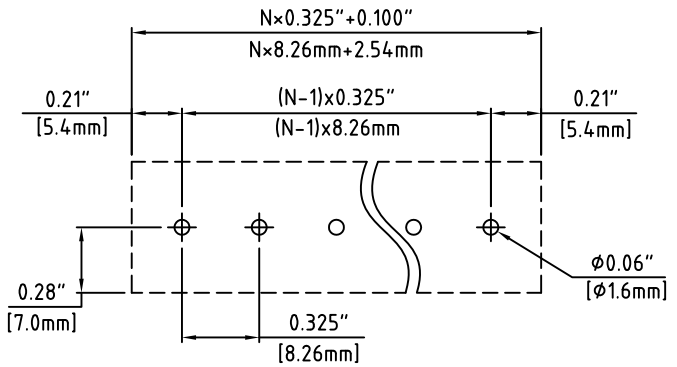

P.C.B. Layout

Material:	
Contact Solder Pin:	Brass, Tin Plated
Screw:	M3, Steel, Ni Plated
Insulating Body:	Polyamide, UL94V-0, Black
Electrical	
Voltage Rating:	300 VAC
Current rating:	15 AMPS
Wire Range:	14-26 AWG
Withstand Voltage:	2500 VAC, Test time 60 seconds
Mechanical	
Torque:	8.0 lbs-in Max
Operating Temperature:	-40°C to +105°C -40°F to +221°F
Soldering Temperature:	260°C, 500°F for 5 seconds max.
Safety Approval:	

### Part Number Configuration

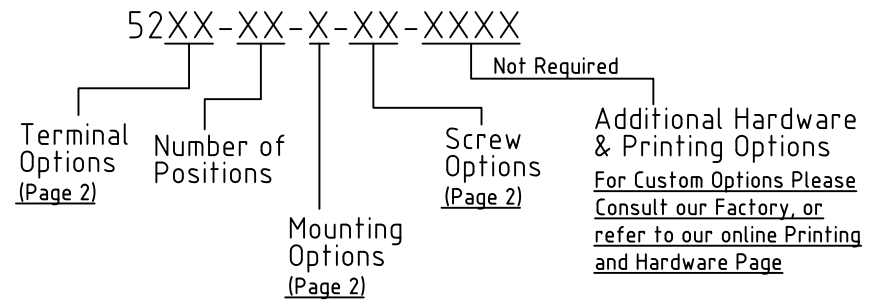

Max Number of Positions = 16

UNLESS OTHERWISE SPECIFIED BREAK ALL SHARP EDGES AND DEBURR ALL HOLES	TITLE: 0.325" SPACING, BARRIER BLOCK	
	LIMITS: UNLESS OTHERWISE SPECIFIED HUND. ± 0.2 THOU. ± 0.05	SCALE: THIS IS A CONFIDENTIAL DRAWING AND MUST BE TREATED AS SUCH. NO DISTRIBUTION IS ALLOWED WITHOUT WRITTEN APPROVAL BY EBY ELECTRO INC.
		PLAINVIEW, NY 11803

**IMPORTANT DISCLAIMER:** All information provided on this print is for reference. Always perform your own tests and acquire samples and further information to determine product suitability. While we make effort to provide accurate information, we cannot be responsible for errors either of omission or typographical. EBY Electro, Inc. assumes no responsibility for the use or suitability of any product. All products and specifications are subject to change without prior written notice.

METRIC LIMITS ONE PLACE ± 0.3 TWO PLACES ± 0.10 ANGLE ± 1°	DRAWN: JM CHECKED: _____ APPROVED: _____	DATE: 07/12/10 DATE: _____ DATE: _____	SIZE: A	DRAWING NUMBER: 5200-0001	REV.
---	--	--	---------	---------------------------	------

(Pb) RoHS Compliant	Rev.	Description/Eco	Date	By

02 - PC

Terminal  
Options

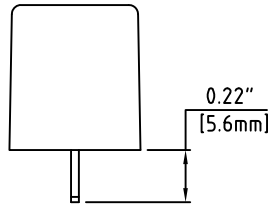

N - No Mounting Ends

Mounting  
Options

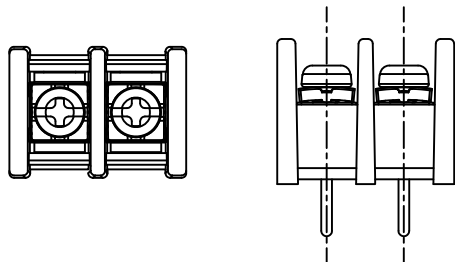

Available Screw  
Options

02 - steel, Zinc plated, w/ Washer

UNLESS OTHERWISE SPECIFIED BREAK ALL SHARP EDGES AND DEBURR ALL HOLES

TITLE: Part Number Configuration for 5200 Series

LIMITS: UNLESS OTHERWISE SPECIFIED  
 HUND. ± 0.2 FRACT. ± 1/64 THOU. ± 0.005 ANGLE ± 1°

SCALE THIS IS A CONFIDENTIAL DRAWING AND MUST BE TREATED AS SUCH. NO DISTRIBUTION IS ALLOWED WITHOUT WRITTEN APPROVAL BY EB Y ELECTRO INC.

**EBY** Electro Inc.  
PLAINVIEW, NY 11803